

DIN 22252 ROUND LINK MINING CHAIN

- DIN 22252 Round Link Chain is used for Armored Face Conveyors (AFC), Beam Stage Loaders (BSL), road header machines, coal plows and other equipment that requires this type of chain.
- Acc to DIN 22252 or PN-G-46701 or GB/T-12718 or GOST 25996 standard.
- Material: 25MnV, RD90L, 23MnNiMoCr54 (Din1.6758), CRNIMO64
- Surface Treatment: Polishing, Carburizing/Carbonitriding, Electro-galvanizing, Hot-dip Galvanizing, Powder Coating, Baking paint, Electrophoresis, Black Oxide, Aluminum Plating, Titanium Plating, etc.

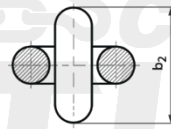
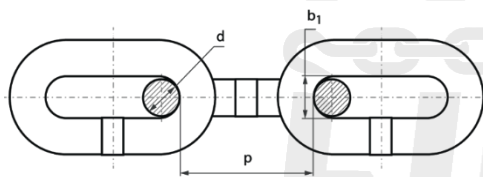

Dimension

Chain Size d x p	Diameter d	Pitch P	b ₁ min.	b ₂ max.	Weight
(mm)	(mm)	(mm)	(mm)	(mm)	(kg/m)
14 x 50	14 ±0.4	50 ±0.5	17	48	4.0
18 x 64	18 ±0.5	64 ±0.6	21	60	6.6
19 x 64.5	19 ±0.6	64.5 ±0.6	22	63	7.4
22 x 86	22 ±0.7	86 ±0.9	26	73	9.5
24 x 86	24 ±0.7	86 ±0.9	28	79	11.6
24 x 87.5	24 ±0.7	87.5 ±0.9	28	79	11.5
26 x 92	26 ±0.8	92 ±0.9	30	85	13.7
30 x 108	30 ±0.9	108 ±1.1	34	97	18.0
34 x 126	34 ±1.0	126 ±1.3	38	110	22.7
38 x 126	38 ±1.1	126 ±1.4	42	121	30.1
38 x 137	38 ±1.1	137 ±1.4	42	121	29.0
42 x 137	42 ±1.1	137 ±1.4	48	137	36.9
42 x 146	42 ±1.1	146 ±1.5	48	137	36.0

Notice:

- All anti-corrosive coatings decrease the chain mechanical properties
- Other sizes can be customized according to customer requirements

DIN 22252 ROUND LINK MINING CHAIN

Mechanical Properties

Chain Size d x p	Chain Grade	Test Force	Breaking Force min.	Elongation at test force max.	Elongation at breaking force min.	Deflection f min.	Fatigue Resistance min.
(mm)		(KN)	(KN)	(%)	(%)	(mm)	(cycles)
14x50	B	150	190	1.4	14	14	50000
	C	200	250	1.6	14	14	70000
	C++	200	280	1.6	18	14	90000
	D	250	310	1.9	16	14	90000
18x64	B	260	320	1.4	14	18	50000
	C	330	410	1.6	14	18	70000
	C++	330	460	1.6	18	18	90000
	D	410	510	1.9	16	18	90000
19x64 19x64.5	B	290	360	1.4	14	19	50000
	C	360	450	1.6	14	19	70000
	C++	360	510	1.6	18	19	90000
	D	450	565	1.9	16	19	90000
22x86	B	380	490	1.4	14	22	50000
	C	490	610	1.6	14	22	70000
	C++	490	680	1.6	18	22	90000
	D	610	760	1.9	16	22	90000
24x86 24x87.5	B	460	570	1.4	14	24	50000
	C	580	720	1.6	14	24	70000
	C++	580	815	1.6	18	24	90000
	D	720	900	1.9	16	24	90000
26x92	B	540	670	1.4	14	26	50000
	C	640	850	1.6	14	26	70000
	C++	700	960	1.6	18	26	90000
	D	790	1060	1.9	16	26	90000
30x108	C	850	1130	1.6	14	30	70000
	C++	950	1280	1.6	18	30	90000
	D	1050	1400	1.9	16	30	90000
34x126	C	1080	1450	1.6	14	34	70000
	C++	1200	1650	1.6	18	34	90000
	D	1350	1800	1.9	16	34	90000
38x126 38x137	C	1360	1810	1.6	14	38	70000
	C++	1500	2040	1.6	18	38	90000
	D	1700	2270	1.9	16	38	90000
42x137 42x146	C	1660	2220	1.6	14	42	70000
	C++	1800	2500	1.6	18	42	90000
	D	2070	2770	1.9	16	42	90000