

DIN22258-1 UNIVERSAL LOCK TYPE RAPID CONNECTING LINKS

- The universal lock type rapid connecting links is used to connect vertical or horizontal mining round link chain, and can also be used on scraper conveyor and coal plow. The special material selection and small tolerance ensure that the arc tooth link ring is easy to install.

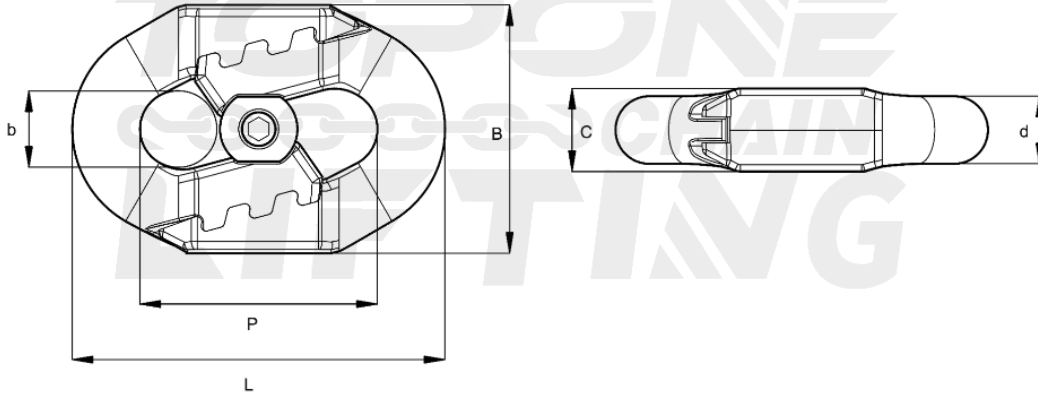

- Ensure the cleanliness of the mounting surface and locking surface.
- Regular inspection for wear and damage.
- It is not allowed to insert other accessories between the two chainrings.
- Inspection is conducted every three months or after 1 million tons of coal is transported.
- Insert the two half rings into the chain and buckle them together, and drive in the middle fixing pin to prevent them from loosening.

Chain Size	d (mm)	P (mm)	L		b		B		C		Proof Load MPL		Breaking Load MBL		Fatigue Resistance (cycles)	Weight (kg)
			max. (mm)	min. (mm)	max. (mm)	max. (mm)	DIN (KN)	D (KN)	DIN (KN)	D (KN)						
18x64	18	64	102	20	72	24	305	420	361	480	40000	0.7				
22x86	22	86	132	24	84	28	456	640	540	715	40000	1.3				
24x86	24	86	136	26	85	30	543	760	642	845	40000	1.5				
26x92	26	92	146	29	96	33	637	830	754	1000	70000	2.0				
30x108	30	108	170	33	109	36	848	1100	1000	1330	70000	3.0				
34x126	34	126	196	37	121	41	1090	1400	1290	1690	70000	4.3				
38x126	38	126	204	41	137	46	1360	1770	1610	2120	70000	5.4				
38x137	38	137	215	41	134	46	1360	1770	1610	2120	70000	5.8				
38x146	38	146	224	41	137	46	1360	1770	1610	2120	70000	6.1				
42x146	42	146	235	45	150	53	1660	2160	1970	2560	70000	7.4				